

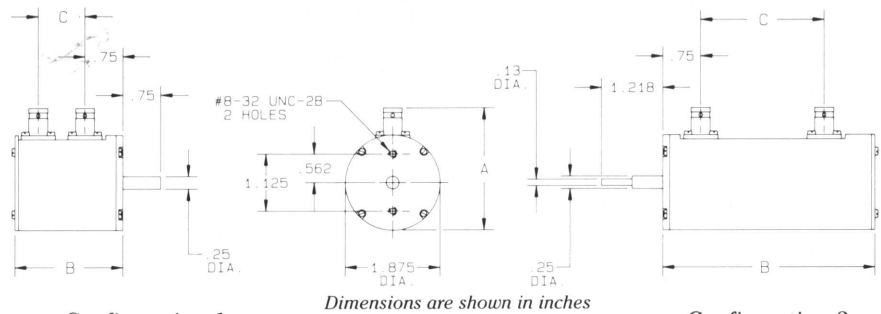

5000 Series

The 5000 Series Turret Attenuators are 50Ω devices, and cover the frequency range of DC to 2000 MHz. Their positive detent action provides long life for applications such as general purpose test and measurement instrumentation, Two-Way Communications and general laboratory accessories. Their construction is suitable for both military or commercial applications.



Configuration 1

Dimensions are shown in inches

Configuration 2

Models	5001	5010A	5035A	5070	5080H
Attenuation (dB)	0-1 in 0.1 dB steps	0-10 in 1 dB steps	0-35 in 5 dB steps	0-70 in 10 dB steps	0-80 in 1 dB steps
Frequency Range (MHz)	DC to 1200	DC to 2000			
Impedance (Ohms)	50				
Insertion Loss (dB)	1.3 dB	0.4 max	0.3 max	1.5 max	2.5 max
Accuracy (dB)* To 500 MHz To 1000 MHz To 2000 MHz	±0.1 (To 1200 MHz)	±0.2 ±0.3 ±0.3	±0.5 ±1.0 ±3.0	±0.5 ±1.0 ±3.0	10 dB steps: ±0.6 1 dB steps: ±0.3 ±1.0 ±0.4 ±3.0 ±0.5
VSWR	1.30:1 max	1.3:1 max to 1000 MHz 1.4:1 max to 2000 MHz	1.4:1 max to 1000 MHz 1.6:1 max to 2000 MHz	1.3:1 max to 1000 MHz 1.5:1 max to 2000 MHz	1.4:1 max to 1000 MHz 1.6:1 max to 2000 MHz
Max Input Power (Watts)	2	0.5			
Angle Between Steps	30°		45°		30° to 1 dB step 40° to 10 dB step
Configuration	1	1	1	1	2
Connectors	BNC Jack, (SMA, TNC and N available)				
Dimensions A B C	6.2 cm (2.44 in.) BNC, TNC; 6.4 cm (2.5 in.) SMA; 7.0 cm (2.75 in.) Type N. 5.4 cm (2.13 in.) 2.1 cm (0.84 in.)				
			7.0 cm (2.75 in.) 3.8 cm (1.5 in.)	10.7 cm (4.19 in.) 6.2 cm (2.44 in.)	

* All accuracy is referenced to the minimum loss position